



EXPO-MED

Serving Health & Medical Division Since 1990

07

Kieferorthopädie

Orthodontics



EM-4086-101 Composite ball plugger, Ø 1,2 / 1,6 mm

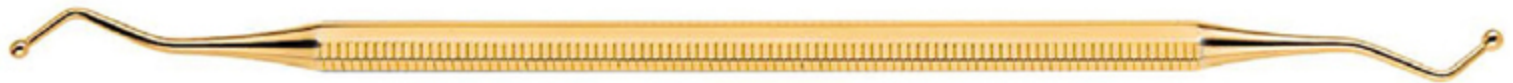

EM-4086-102 Composite ball plugger, Ø 2,0 / 2,5 mm

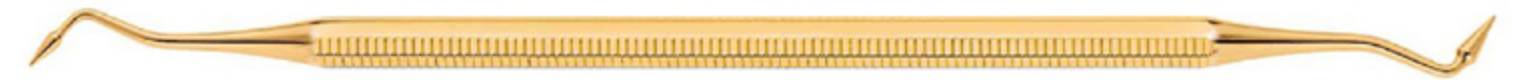

EM-4086-125 Composite cone burnisher, for occlusalen modelling



EM-4086-126 WESTCOTT composite burnisher, 2,0 / 3,0 mm, „Duckhead“ for posterior fissures and cuspids



EM-4086-127 WESTCOTT composite burnisher, 2,5 / 3,5 mm, „Duckhead“ for posterior fissures and cuspids



EM-3902-0 Ball plugger, Ø 1,0 / 0,8 mm



EM-3902-1 Ball plugger, Ø 1,6 / 1,2 mm



EM-3902-2 Ball plugger, Ø 2,5 / 2,0 mm



EM-3902-3 Ball plugger, Ø 3,2 / 2,8 mm



EM-3902-92 Ball plugger, Ø 2,5 / 1,6 mm



EM-3902-4 Pear plugger, Ø 0,8 / 1,0 mm



EM-3902-5 Pear plugger, Ø 1,2 / 1,6 mm



EM-3902-6 Pear plugger, Ø 2,0 / 2,5 mm



EM-3424 PCH Calcium hydroxide placer, also for base/liner placement



EM-3425 PCH Calcium hydroxide placer, also for base/liner placement



EM-3902-8 Plugger, Ø 1,0 / 0,8 mm, serrated



EM-3902-10 Plugger, Ø 2,5 / 2,0 mm, serrated



EM-3910-1 BLACK Plugger FIG. 153, Ø 2,5 / 1,5 mm, serrated



EM-3902-29 Plugger, Ø 1,0 / 0,8 mm



EM-3902-30 Plugger, Ø 1,6 / 1,2 mm



EM-3902-37 Plugger, Ø 2,0 / 1,6 mm



EM-3902-26 Spatula / Ball plugger, 2,0 / Ø 1,0 mm



EM-3902-27 Spatula / Ball plugger, 2,5 / Ø 1,6 mm



EM-3902-28 Spatula / Ball plugger, 3,2 / Ø 2,5 mm



EM-3902-46 Spatula / Pear plugger, 2,0 / Ø 1,0 mm



EM-3902-47 Spatula / Pear plugger, 2,5 / Ø 1,6 mm



EM-3904-50 DYCAL, Ø 0,6 / 0,9 mm



EM-3904-51 DYCAL, Ø 0,6 / 0,9 mm



EM-3904-207 Mini Spatula / DYCAL, 1,6 / Ø 0,8mm



EM-3940-1 Planator, Ø 1,7 / 1,4 mm



EM-3940-2 Planator, Ø 2,3 / 1,9 mm



EM-3907-1 Ball plugger, Ø 1,6 / 1,2 mm



EM-3907-2 Ball plugger, Ø 2,5 / 2,0 mm



EM-3907-3 Ball plugger, Ø 3,2 / 2,8 mm



EM-3907-4 Pear plugger, Ø 0,8 / 1,0 mm



EM-3907-5 LADMORE pear plugger, Ø 1,2 / 1,6 mm



EM-3907-6 Plugger, Ø 2,0 / 2,5 mm



EM-3904-103 Spatula, 1,6 / 1,6 mm



EM-3907-13 Spatula, 2,5 / 2,5 mm



EM-3907-14 Spatula, 3,2 / 3,2 mm



EM-3904-3 Spatula, 1,8 / 2,0 mm



EM-3904-7 Spatula, 1,8 / 1,8 mm
FIG. 179



EM-3915-154 plugger Ø 2,7 / 1,6 mm
GUY



EM-3915-155 HOPSON ball plugger, Ø 2,5 / 1,7 mm



EM-3936 MORTONSON burnisher, Ø 1,5 / 1,1 mm



EM-4122 WESTCOTT burnisher, Ø 2,8 / 3,1 mm
FIG. 21B



EM-4126-1 WESTCOTT burnisher, Ø 3,0 / 2,5 mm



EM-4136 WILAND Carving instrument, occusal / approximal



EM-4430 HOLLENBACK Carving instrument
FIG. 3



EM-4430-15 HOLLENBACK Carving instrument
FIG. 35



EM-4432-1 WARD Carving instrument



EM-4426-1 NYSTRÖM Carving instrument 2,3 mm
N1



EM-4426-2 NYSTRÖM Carving instrument 2,1 mm
N2



EM-4426-3 NYSTRÖM Carving instrument 1,8 mm
N3



EM-4134-89 CLEOID DISCOID Carving instrument



EM-4454 FRAHM Carving instrument, 45° angled



EM-3453-28 Gingival margin trimmer, 10-95-7-14, 1,0 mm, distal



EM-3453-29 Gingival margin trimmer, 10-80-7-14, 1,0 mm, mesial



EM-4112-10 Filling remover



EM-3452-77 BLACK Filling remover, 15-95-8-12, 1,5 mm, distal
FIG. 77/78



EM-3452-79 BLACK Filling remover, 15-80-8-12, 1,5 mm, mesial
FIG. 79/80



EM-3476-5 Excavator, Ø 1,2 mm



EM-3476-17 Excavator, Ø 1,3 mm
FIG. 17



EM-3476-18 Excavator, Ø 1,5 mm
FIG. 18



EM-3476-19 Excavator, Ø 2,0 mm
FIG. 19



EM-3476-20 Excavator, Ø 2,5 mm
FIG. 20



EM-3462-39 Excavator, Ø 1,1 mm



EM-3462-37 Excavator, Ø 1,5 mm



EM-3462-35 Excavator, Ø 1,8 mm



EM-3462-33 Excavator, Ø 2,0 mm
FIG. 127/128



EM-3462-31 Excavator, Ø 2,5 mm
FIG. 125/126



EM-3462-55 Excavator, Ø 1,7 mm
FIG. 129/130



EM-3462-57 Excavator, Ø 1,4 mm
FIG. 131/132



EM-3462-243 Excavator, Ø 1,0 mm
FIG. 243



EM-3462-244 Excavator, Ø 1,4 mm
FIG. 244



EM-3462-245 Excavator, Ø 2,0 mm
FIG. 245



EM-3470-218 DARBY-PERRY Excavator, Ø 1,2 mm
FIG. 218/219



EM-3470-220 DARBY-PERRY Excavator, Ø 1,5 mm
FIG. 220/221



EM-3665
TC 14,5 cm



EM-4890
MILLER
Forceps for articulating paper, straight



EM-4890-1
MILLER
Forceps for articulating paper, curved



EM-3761-1
without illustration
Metal replacement tip

EM-3761
15,0 cm
Amalgam carrier, sterilizable up to 140°C



EM-3765-1
without illustration
Metal replacement tip

EM-3765
13,0 cm
Amalgam carrier, sterilizable up to 140°C

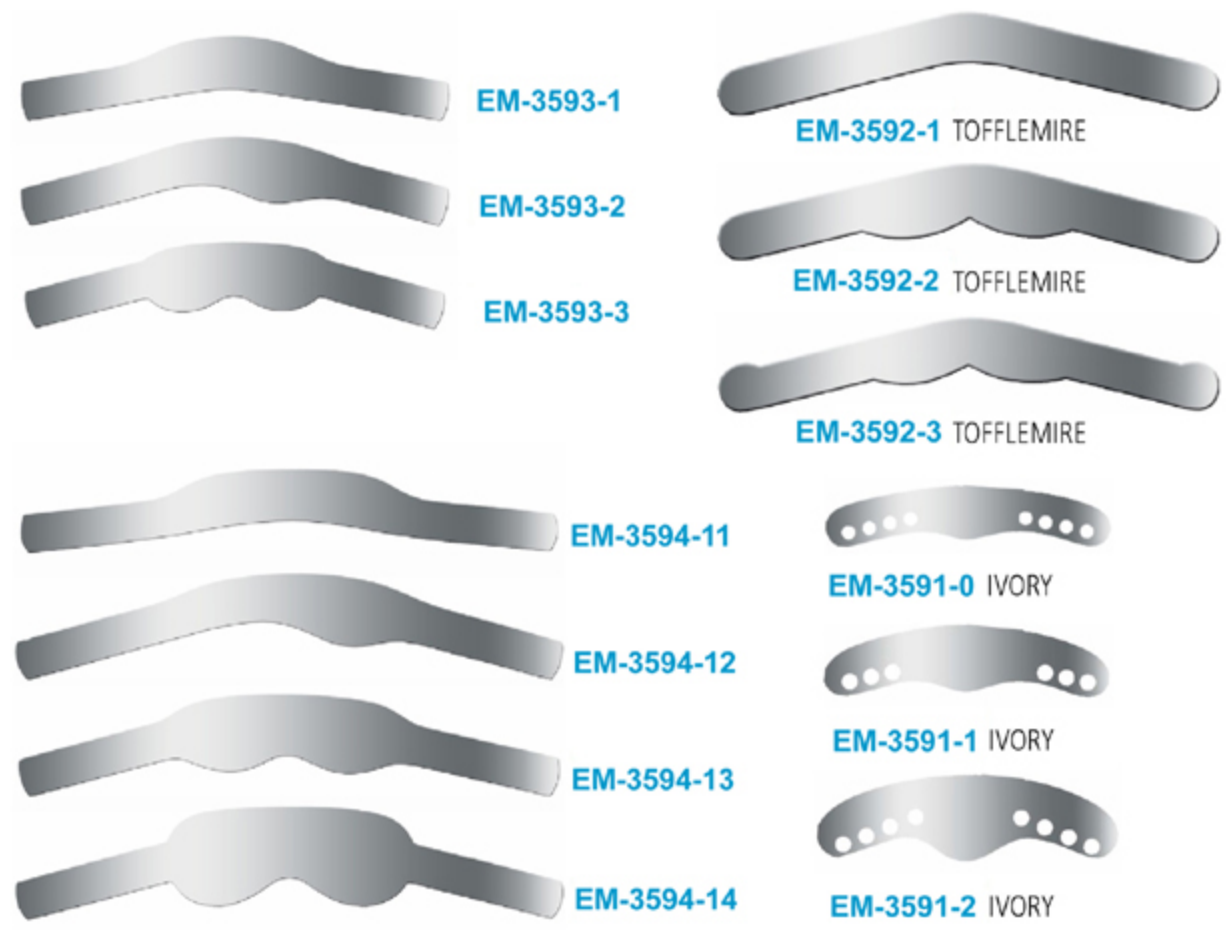
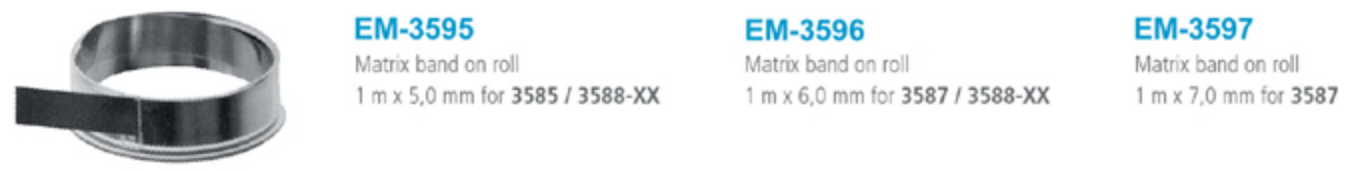
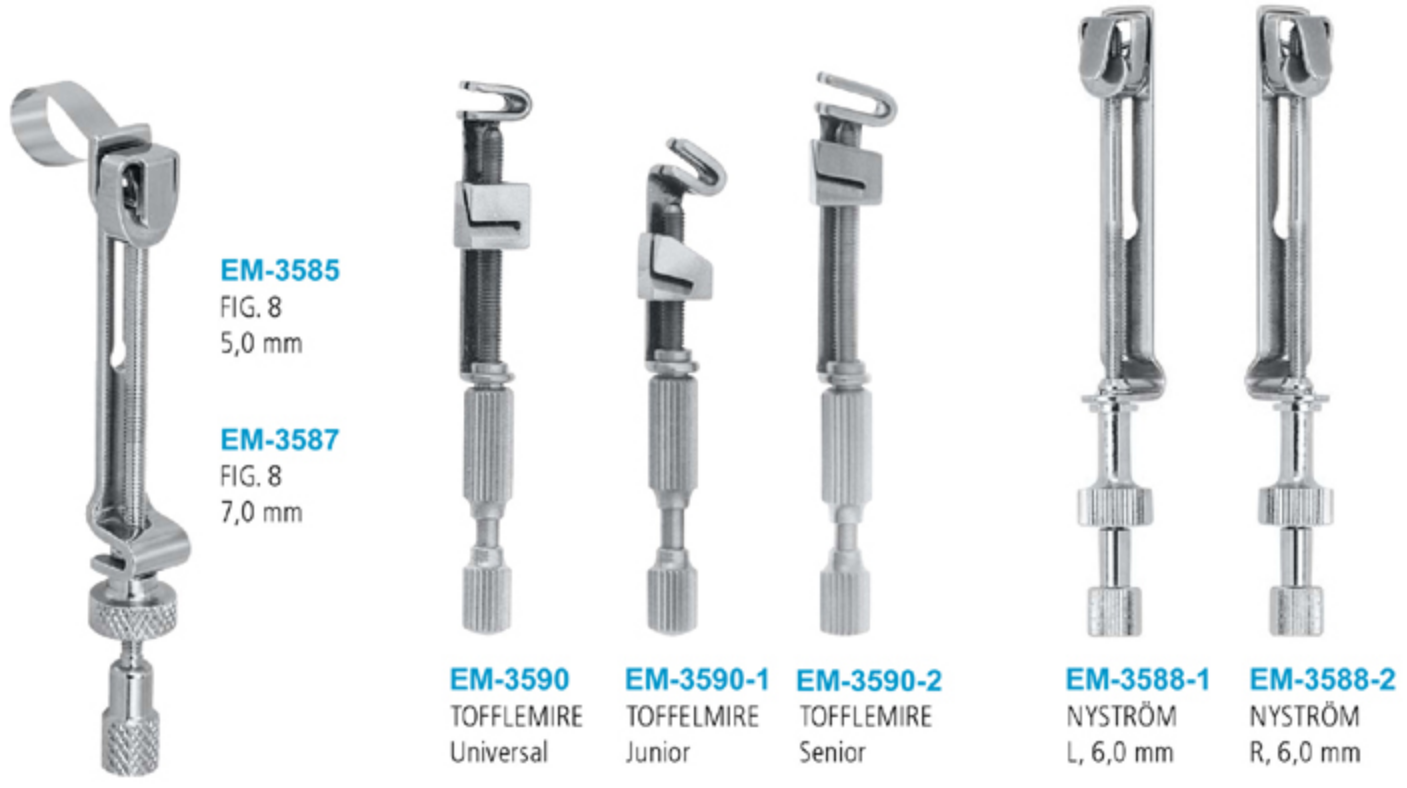



7. Konservierung · Restorative

Zementspatel · Cement spatulas



EM-4327 8,8 mm



EM-4310 3,5 / 4,0 mm



EM-4340 FIG. 8, 8,0 / 8,0 mm



EM-4342-1 5,5 / 5,5 mm



EM-4342-2 6,5 / 6,5 mm



EM-4342-3 8,0 / 8,0 mm



EM-3763
95 x 70 x 6 mm
Maxing slab, glass

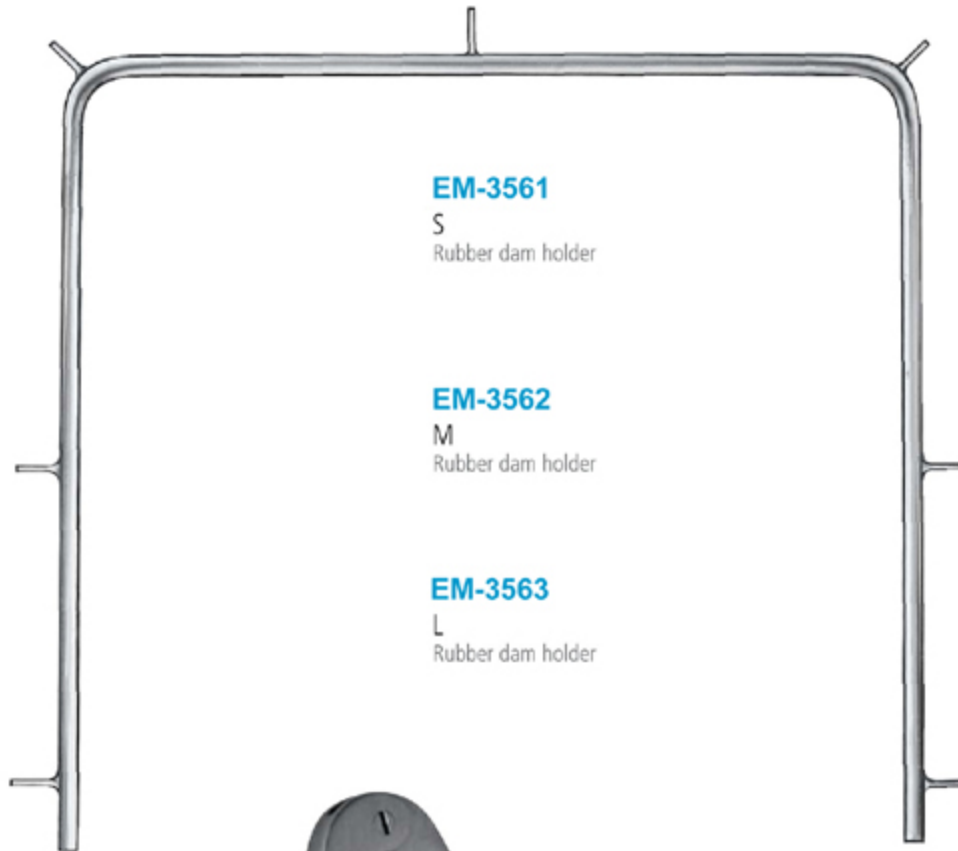



7. Konservierung · Restorative

Klammerzangen / Wurzelkanalinstrumente · Clamp forceps / Root canal instruments



EM-3555
STOKE
17,0 cm
Clamp forceps

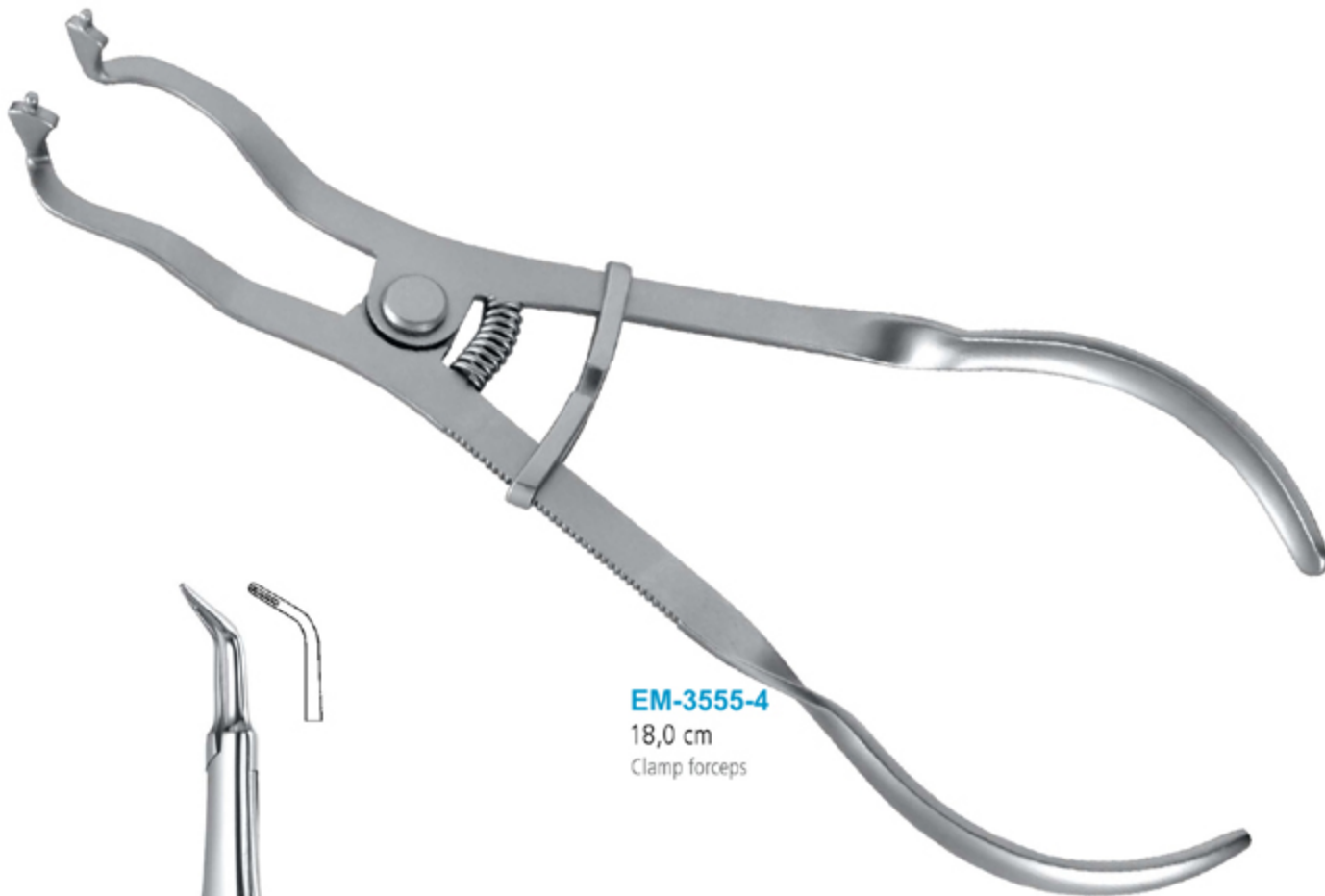

EM-3555-4
18,0 cm
Clamp forceps



EM-3661

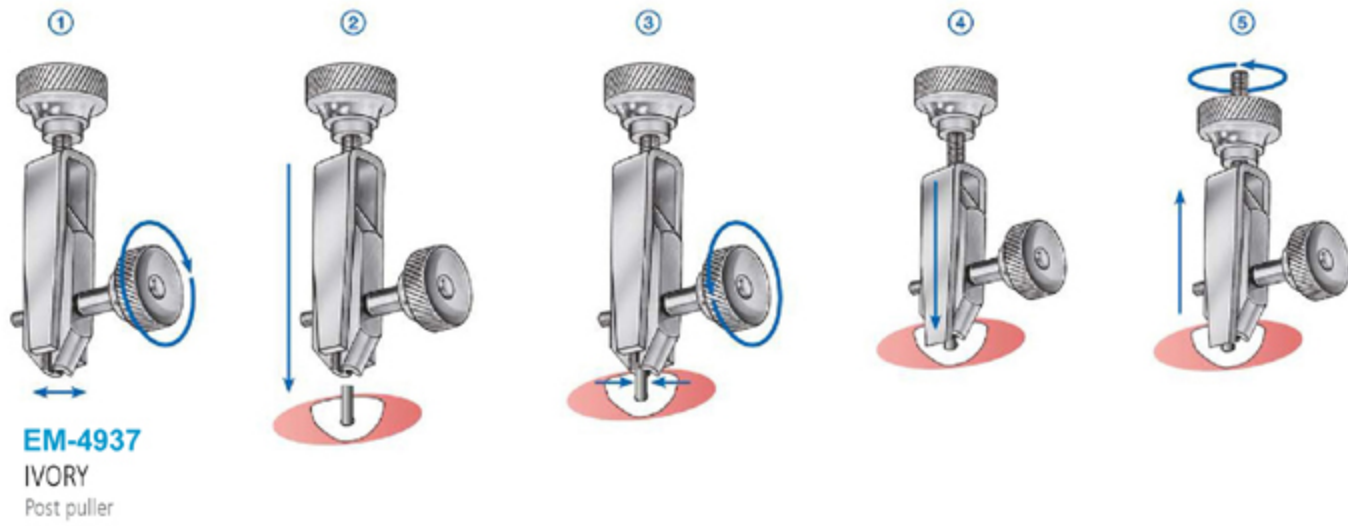



EM-3625-03 LUKS Root canal plugger, Ø 0,3 mm



EM-3625-04 LUKS Root canal plugger, Ø 0,4 mm



EM-3625-06 LUKS Root canal plugger, Ø 0,6 mm



EM-3625-09 LUKS Root canal plugger, Ø 0,9 mm



EM-3627-03 Root canal plugger, Ø 0,3 mm, graduation 5/10/15/20



EM-3627-04 Root canal plugger, Ø 0,45 mm, graduation 5/10/15/20



EM-3627-06 Root canal plugger, Ø 0,6 mm, graduation 5/10/15/20



EM-3627-09 Root canal plugger, Ø 0,9 mm, graduation 5/10/15/20



EM-3632-1 GLICK Root canal plugger for gutta percha application